

PART PLAN
HOTEL BAR SHELVING ELEVATION REFERENCES
SCALE 1:100

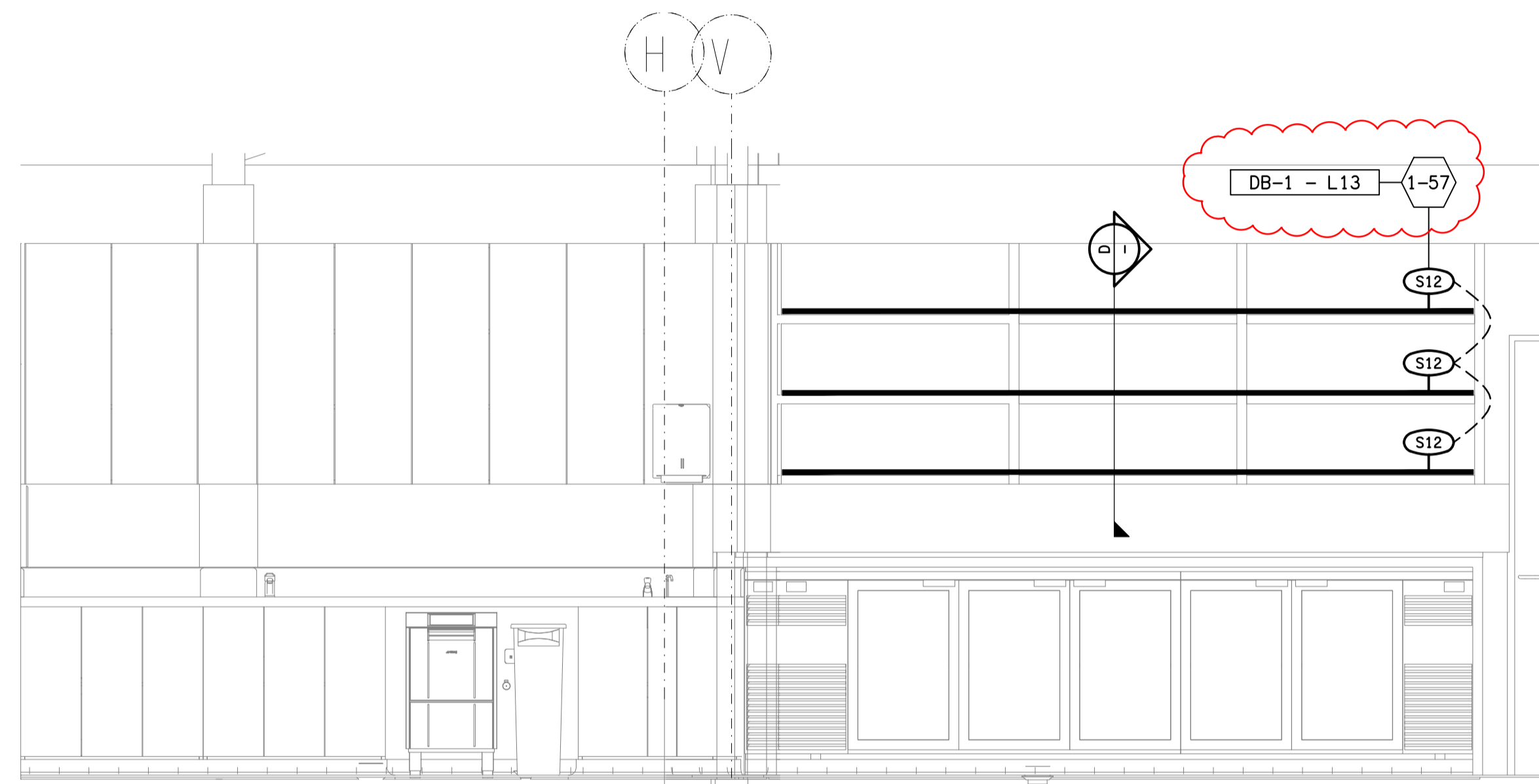

DETAIL A
BAR 2 LIGHTING ELEVATION
SCALE 1:25

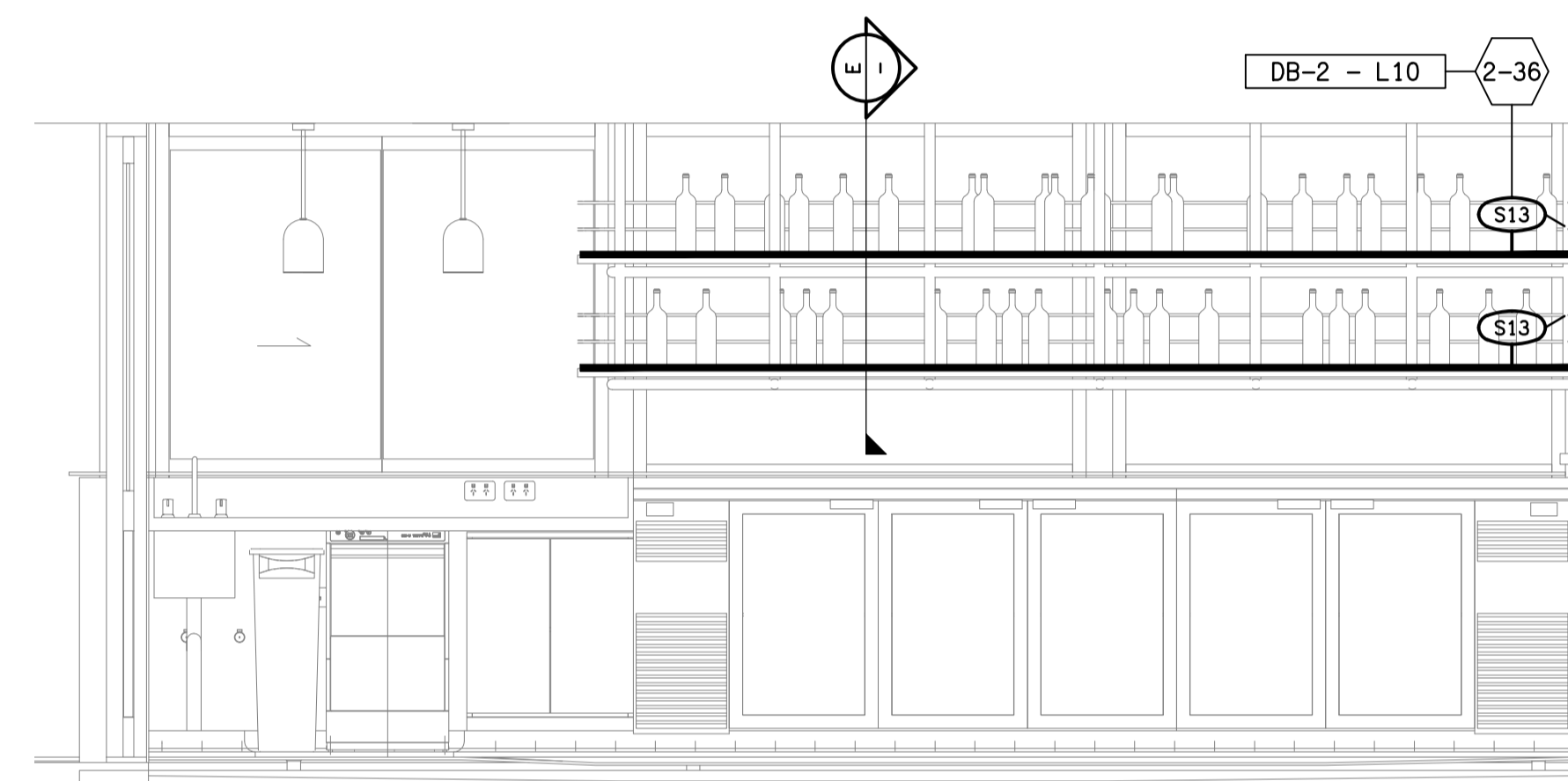

DETAIL C
OYSTER SHED BAR LIGHTING ELEVATION
SCALE 1:25

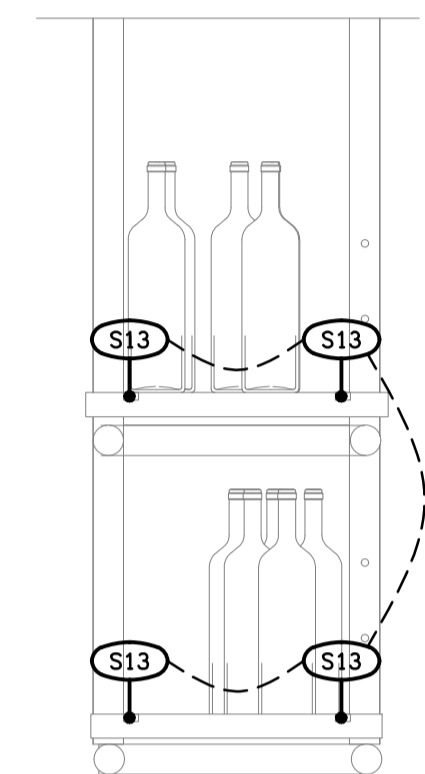

DETAIL E
OYSTER SHED BAR LIGHTING SECTION
SCALE 1:10

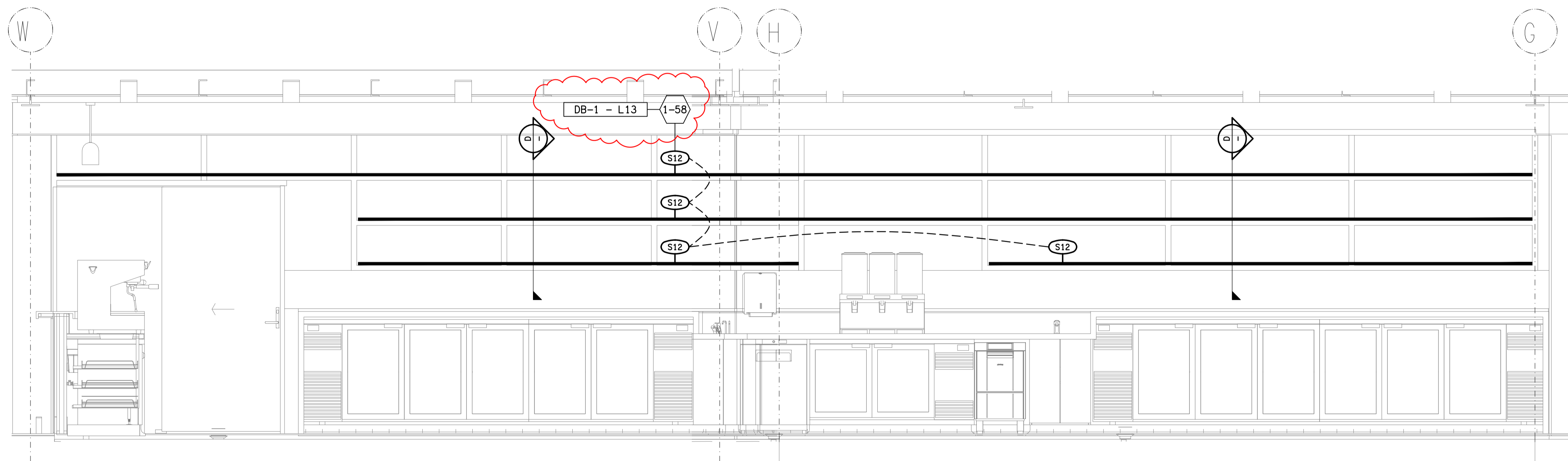

DETAIL B
MAIN BAR LIGHTING ELEVATION
SCALE 1:25

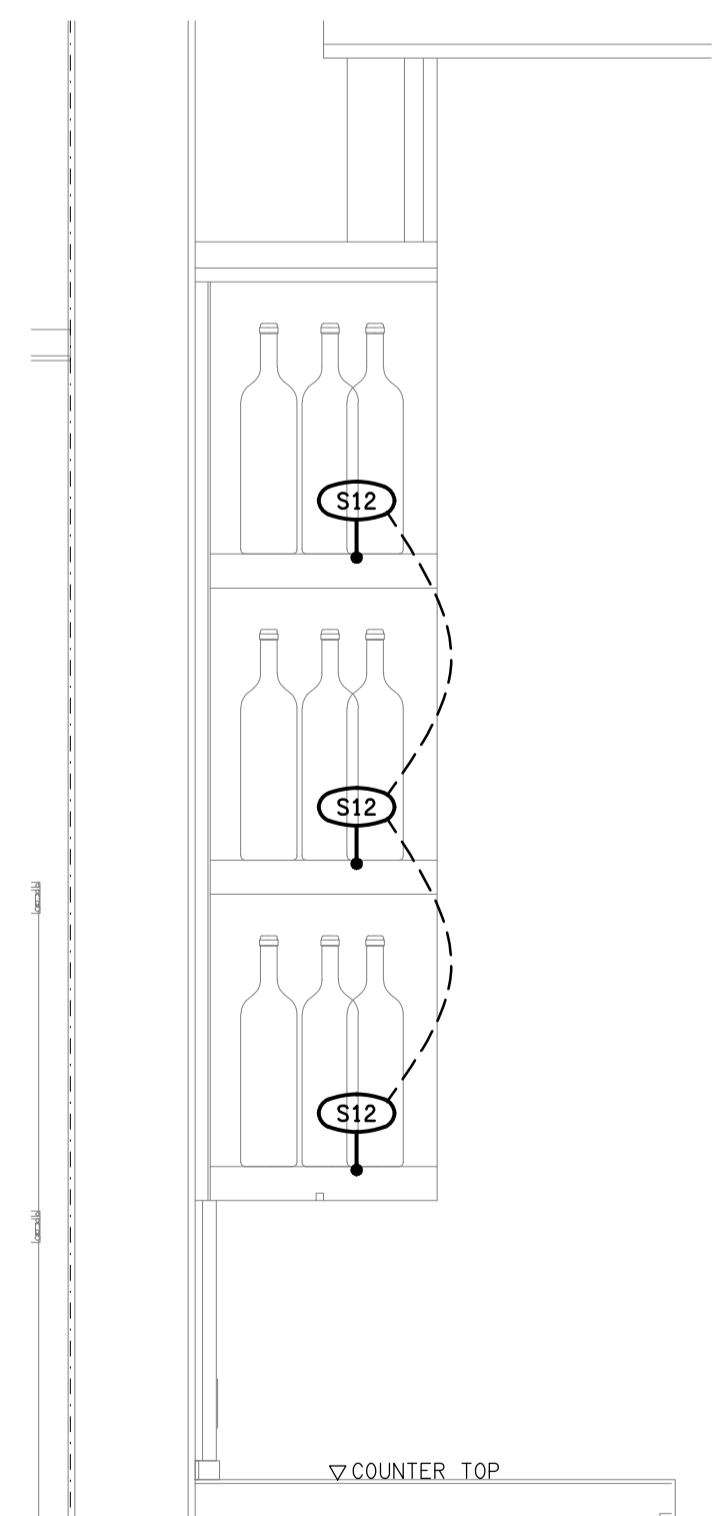

DETAIL D
TYPICAL SHELVING LIGHTING SECTION
SCALE 1:10

ELECTRICAL DESIGN GROUP BRISBANE
PTY LTD
ACN 092 710 793
TRADING AS:
ELECTRICAL DESIGN GROUP

THE COPYRIGHT OF THIS DRAWING
REMAINS THE PROPERTY OF THE
ELECTRICAL DESIGN GROUP.
USE FIGURED DIMENSIONS
IN PREFERENCE TO SCALE.
ALL DIMENSIONS TO BE
VERIFIED ONSITE.

ELECTRICAL DESIGN GROUP
ELECTRICAL BUILDING SERVICES CONSULTANTS
BRISBANE GOLD COAST

P.O. Box 15, Sherwood Q.4075
Phone: (07) 3278 4375
Email: brisbane@edg.net.au
Web: www.edg.net.au

PROJECT:
DRY DOCK ROAD HOTEL,
TWEED HEADS SOUTH

CORNER DOCK ROAD & FRASER DRIVE, NEW SOUTH WALES

B	CONSTRUCTION	28/05/2026
REV.	DESCRIPTION:	DATE:

DRAWING:
ELECTRICAL SERVICES
HOTEL BAR SHELF LIGHTING ELEVATIONS

SCALE:
AS SHOWN AT A1

PROJECT NO:
C2864a

DRAWING NO:
E14

REVISION:
B